

# 1791-B Sportsman Lane - HUNTSVILLE, AL

## FLEX SPACE FOR LEASE



### PROPERTY HIGHLIGHTS

- Property features 12' x 12' drive-in garage door for easy shipping and receiving.
- Easy access to major roads including Jordan Lane, University Drive, and Memorial Parkway.
- Ample parking available for employees and clientele.
- Electrical outlets throughout the space.

### ABOUT THE PROPERTY

1791-B Sportsman Lane is a warehouse building with flex space that includes two offices, two bathrooms, and plenty of open warehouse space. The property is easily accessible from Jordan Lane, Memorial Parkway, and University Drive.

### LOCATION

1791-B Sportsman Lane  
Huntsville, AL 35816

### SPACE AVAILABLE

3,000 SF Of Flex Space

### PRICE

Please call for pricing information.

### FOR MORE INFORMATION CALL

Eric St. John  
256-536-8809



**CRUNKLETON**  
COMMERCIAL REAL ESTATE GROUP



MAP SHOWING PROPERTY LOCATION



1791 SPORTSMAN LN.



**DOLLAR GENERAL**

**Arby's**

**WELLS FARGO**

**Jack's**

**BBVA Compass**

**W**  
Telegrams

**WH**  
WAFFLE HOUSE

**Days Inn & Suites**

**REGIONS**

**SONIC**  
America's Drive-In

**THE UNIVERSITY OF ALABAMA IN HUNTSVILLE**

**DOWNTOWN HUNTSVILLE**

**VBC**  
VON BRAUN CENTER

**HUNTSVILLE HOSPITAL**

**MILTON FRANK STADIUM**

**WHOLE FOODS**  
MARKET

**HUNTSVILLE BOTANICAL GARDEN**

**Kroger**



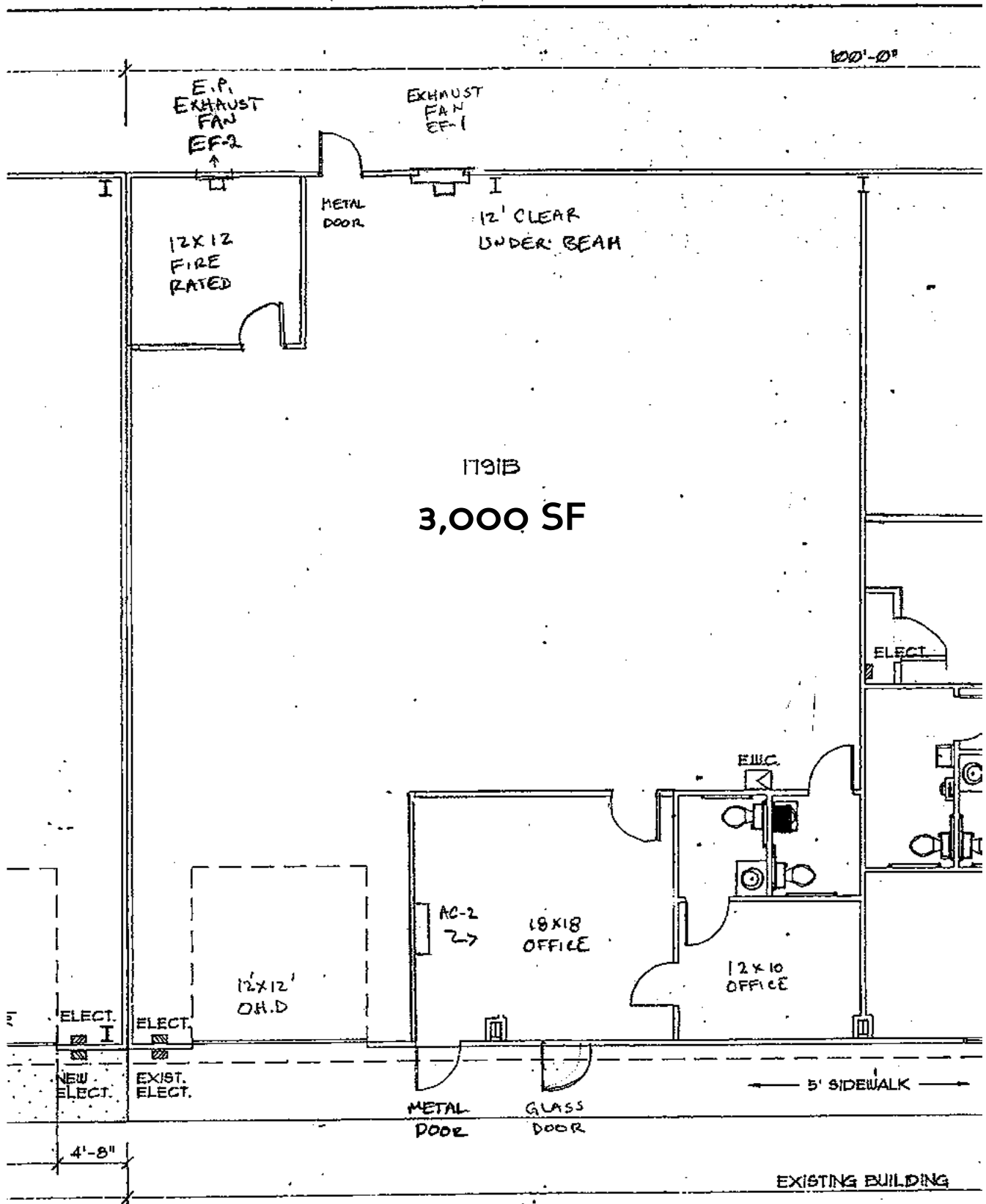

# FLOOR PLAN