

1791 Sportsman Lane - HUNTSVILLE, AL

FLEX SPACE FOR LEASE



PROPERTY HIGHLIGHTS

- Property features 12' x 12' drive-in garage door for easy shipping and receiving.
- Easy access to major roads including Jordan Lane, University Drive, and Memorial Parkway.
- Ample parking available for employees and clientele.
- Electrical outlets throughout the space.

AVAILABLE SUITES

Suite B - 3,000 SF
Suite C/D - 6,000 SF
(*Can be combined.)

ABOUT THE PROPERTY

1791 Sportsman Lane is a warehouse building with flex space that includes two offices, two bathrooms, and plenty of open warehouse space. The property is easily accessible from Jordan Lane, Memorial Parkway, and University Drive.

LOCATION

1791 Sportsman Lane
Huntsville, AL 35816

SPACE AVAILABLE

9,000 SF Of Flex Space*

PRICE

Please call for pricing information.

FOR MORE INFORMATION CALL

Eric St. John
256-536-8809



CRUNKLETON
COMMERCIAL REAL ESTATE GROUP

MAP SHOWING PROPERTY LOCATION



1791 SPORTSMAN LN.

DOLLAR GENERAL

Arby's

WELLS FARGO

Jack's

BBVA Compass

REGIONS

SONIC
America's Drive-In

THE UNIVERSITY OF ALABAMA IN HUNTSVILLE

HUNTSVILLE BOTANICAL GARDEN

Telegrams

Waffle House

Days Inn & Suites

MILTON FRANK STADIUM

DOWNTOWN HUNTSVILLE

VBC
VON BRAUN CENTER

HUNTSVILLE HOSPITAL

WHOLE FOODS
MARKET

Kroger

Walmart
Save money. Live better.

TACO BELL

Krispy Kreme
DOUGHNUTS

Red Lobster

THE HOME DEPOT

BAM!
BOOKS & MORE

HIGHWAY 72

JORDAN LANE

JORDAN LANE

MEMORIAL PARKWAY

MEMORIAL PARKWAY

I-565

I-565

I-565

I-565

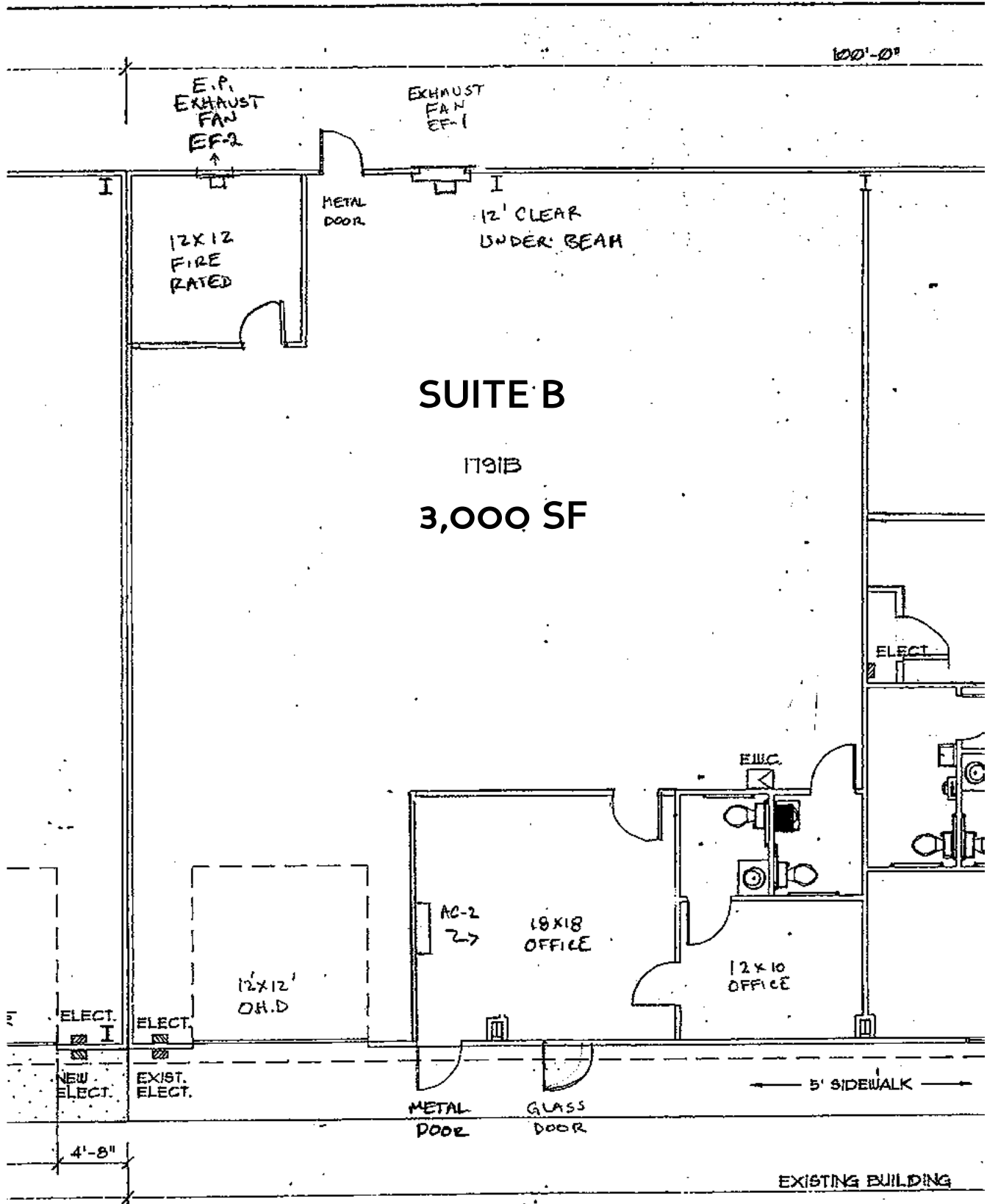

FLOOR PLAN